

# INSTALLATION INSTRUCTIONS

## 525 / 526 OUTSIDE ACCESS DEVICE

### NOTES ON INSTALLATION

THIS OUTSIDE ACCESS DEVICE (OAD) PROVIDES LEVER / KNOB OPERATED LOCKING ENTRY WITH MASTER KEYING FACILITY.

THIS DEVICE IS SUITABLE FOR USE ON DOORS TOGETHER WITH **EXIDOR 500 SERIES** PANIC & EMERGENCY EXIT HARDWARE.

THIS DEVICE ALWAYS ALLOWS IMMEDIATE EXIT VIA THE PANIC / EMERGENCY EXIT HARDWARE REGARDLESS OF WHETHER THE OUTSIDE ACCESS DEVICE IS LOCKED OR UNLOCKED.

THIS DEVICE CAN BE FITTED AS PART OF THE INITIAL INSTALLATION OF THE PANIC / EMERGENCY EXIT HARDWARE OR RETROFITTED TO AN EXISTING INSTALLATION.

FOR DOUBLE DOOR INSTALLATIONS WITH REBATED MEETING STILES USED TOGETHER WITH DOUBLE DOOR PANIC / EMERGENCY EXIT SYSTEMS THE OAD MUST BE FITTED ON THE FIRST OPENING (LAST CLOSING) LEAF.

BEFORE INSTALLATION CHECK THAT BOTH THE FRAME AND DOOR ARE IN GOOD CONDITION, NOT TWISTED AND FREE FROM BINDING. ENSURE; THE DOOR IS HUNG ON SUITABLE HINGES, OPENS SMOOTHLY AND CLOSES SQUARE INTO THE FRAME.

THIS EQUIPMENT MUST BE FITTED BY A COMPETENT INSTALLER.

THESE INSTALLATION INSTRUCTIONS MUST BE SUPPLIED TO THE USER BY THE INSTALLER WHEN THE INSTALLATION IS COMPLETE.

IF THESE INSTALLATION INSTRUCTIONS ARE DISREGARDED NO RESPONSIBILITY CAN BE ACCEPTED BY THE MANUFACTURER.

### OPERATION

TO **UNLOCK** THE DEVICE:

INSERT THE KEY, ROTATE CLOCKWISE ONE TURN AND REMOVE.

THE LEVER / KNOB WILL NOW OPERATE THE INSTALLED PANIC / EMERGENCY EXIT DEVICE ON THE INSIDE OF THE DOOR.

TO **LOCK** THE DEVICE:

INSERT THE KEY, ROTATE ANTI-CLOCKWISE ONE TURN AND REMOVE.

WHEN LOCKED THE OPERATION OF THE DEVICE IS DISENGAGED BUT THE LEVER / KNOB WILL MOVE FREELY.

### PRODUCT OPTIONS

PRODUCT CODE	OPERATING ELEMENT (LEVER / KNOB)	CYLINDER SUPPLIED & FITTED (YES / NO)	*KEY RETENTION OPTION
525EC	LEVER	YES	NO
525EA	LEVER	NO	NO
526EC	KNOB	YES	NO
526EA	KNOB	NO	NO
525EC/RK	LEVER	YES	YES
525EA/RK	LEVER	NO	YES
526EC/RK	KNOB	YES	YES
526EA/RK	KNOB	NO	YES

\*KEY RETENTION PREVENTS THE KEY FROM BEING REMOVED WHEN DEVICE IS UNLOCKED.

### DEVICE PREPARATION

A1

#### KNOB VERSION (526) - KNOB ASSEMBLY

- LOCATE THE **WASHER** ONTO THE BODY'S BOSS 'CUPPED' SIDE DOWN (PLAIN SIDE UP).
- LOCATE THE **KNOB** ONTO THE SQUARE SHANK (IN BOSS).
- USING 3mm HEX KEY SECURE WITH THE **M4 x 35 SCREW**.

THE KNOB ROTATES 45° IN EITHER DIRECTION TO A STOP, TO SUIT EITHER LEFT OR RIGHT HAND DOORS.

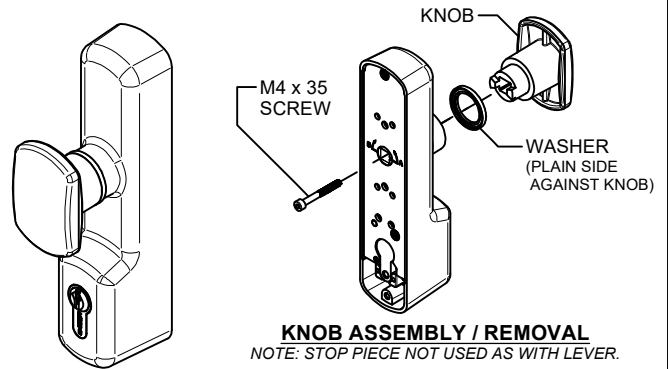

#### KNOB ASSEMBLY / REMOVAL

NOTE: STOP PIECE NOT USED AS WITH LEVER.

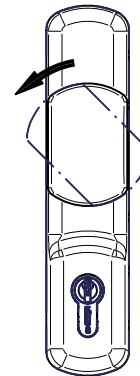

KNOB ACW ROTATION

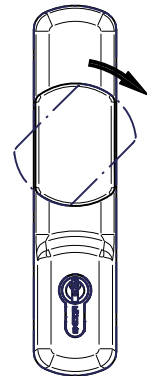

KNOB CW ROTATION

A2

#### LEVER VERSION (525) - LEVER HANDING & ASSEMBLY

- FIT THE LEVER'S **STOP PIECE** INTO THE CORRECT APERTURE, TO SUIT THE DOOR HANDING.
- LOCATE THE **WASHER** ONTO THE BODY'S BOSS 'CUPPED' SIDE DOWN (PLAIN SIDE UP)
- LOCATE THE **LEVER** ONTO THE SQUARE SHANK (IN BOSS) IN THE CORRECT ORIENTATION, TO SUIT THE DOOR HANDING.
- SECURE LEVER TO DEVICE WITH THE SUPPLIED CAP HEAD **M4 x 35 SCREW**, USING 3mm HEX KEY.

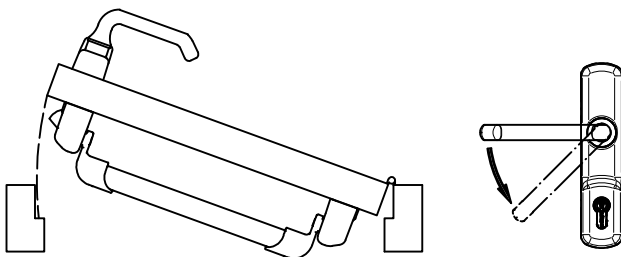

#### LH DOOR

(HINGED ON RIGHT, OPENING OUTWARDS, VIEWED FROM ABOVE)

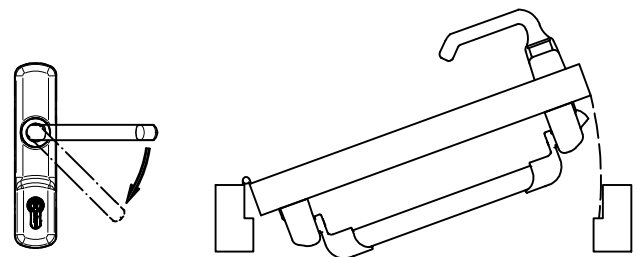
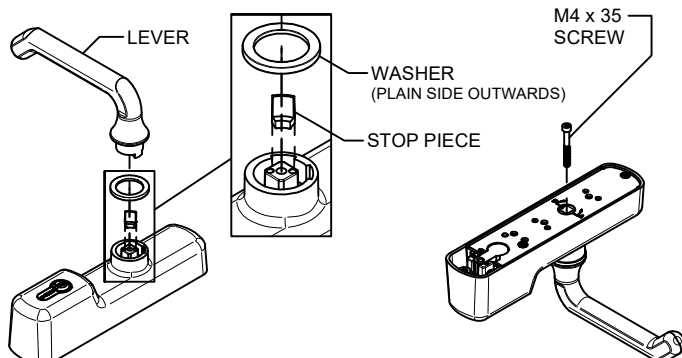

#### RH DOOR

(HINGED ON LEFT, OPENING OUTWARDS, VIEWED FROM ABOVE)

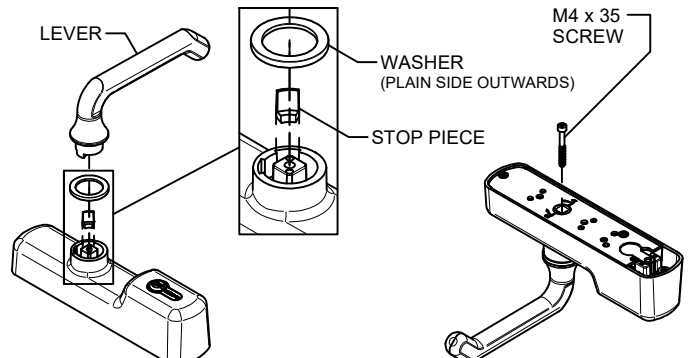

# DEVICE PREPARATION

**B**

## SETTING THE DRIVE SPINDLE HANDING

THE **DRIVE SPINDLE** MUST BE SET TO SUIT THE REQUIRED DOOR HANDING. REFER TO THE DIAGRAMS TO DETERMINE THE REQUIRED POSITION. FOLLOW THE PROCEDURE BELOW TO SET THE POSITION.

1. SELECT THE REQUIRED POSITION A OR B (SEE DIAGRAMS).
2. ENSURE DEVICE IS UNLOCKED. ORIENTATE THE UNIT SO YOU ARE LOOKING AT THE BACK.
2. USING THE END OF THE SUPPLIED SQUARE SPINDLE (IN SCREW PACK):  
TURN THE **DRIVE SPINDLE** TO THE REQUIRED START POSITION (A OR B)  
ALIGN THE SETTING MARK ON THE **DRIVE SPINDLE** WITH THE CORRECT SETTING MARK ON THE BACKPLATE.
3. OPERATE THE **LEVER** TO CHECK ROTATION. THE **DRIVE SPINDLE** SHOULD ROTATE IN THE DIRECTION OF THE RELEVANT ARROW. RE-SET THE **DRIVE SPINDLE** TO ITS START POSITION (AS IN STEP 2)

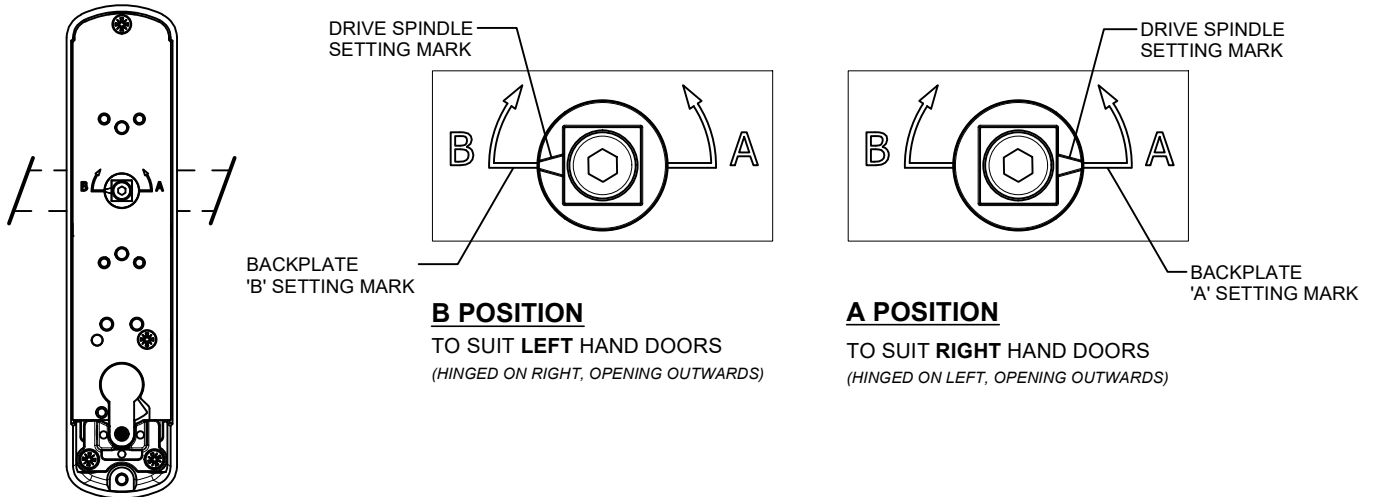

**C**

## CYLINDER INSTALLATION (IF REQUIRED)

1. UNSCREW THE 2 **BRACKET SCREWS**. REMOVE THE **CYLINDER BRACKET** FROM THE UNIT.
2. FIT THE **CYLINDER** INTO THE **CYLINDER BRACKET**.
3. ALIGN THE HOLES & SECURE WITH THE PROVIDED **CYLINDER SCREW (M5 x 20)**.  
**IMPORTANT!** ENSURE THE SCREW IS FITTED FROM THE **RIGHT** HAND SIDE AS SHOWN.
3. INSERT THE **CYLINDER BRACKET / CYLINDER** ASSEMBLY INTO THE UNIT.  
**ENSURE** THE CYLINDER PROFILE LOCATES THROUGH THE PROFILE APERTURE IN THE DEVICE BODY.
4. SECURE WITH THE 2 **BRACKET SCREWS**.
5. TEST THE OPERATION OF THE CYLINDER:
  - ENSURE THAT WHEN LOCKED THE DRIVE SPINDLE DOES NOT ROTATE.
  - ENSURE THAT WHEN UN-LOCKED THE DRIVE SPINDLE ROTATES IN THE REQUIRED DIRECTION (AS SET STEP B)
  - RETURN THE DRIVE SPINDLE TO ITS START POSITION (AS SET STEP B)

## CYLINDER REMOVAL (IF REQUIRED)

1. UNSCREW THE 2 **BRACKET SCREWS**.
2. WITHDRAW THE **CYLINDER BRACKET / CYLINDER** ASSEMBLY FROM THE UNIT.
2. REMOVE THE **CYLINDER SCREW (M5 x 20)** FROM THE **CYLINDER BRACKET / CYLINDER**.
3. WITHDRAW THE **CYLINDER** FROM THE **CYLINDER BRACKET**.

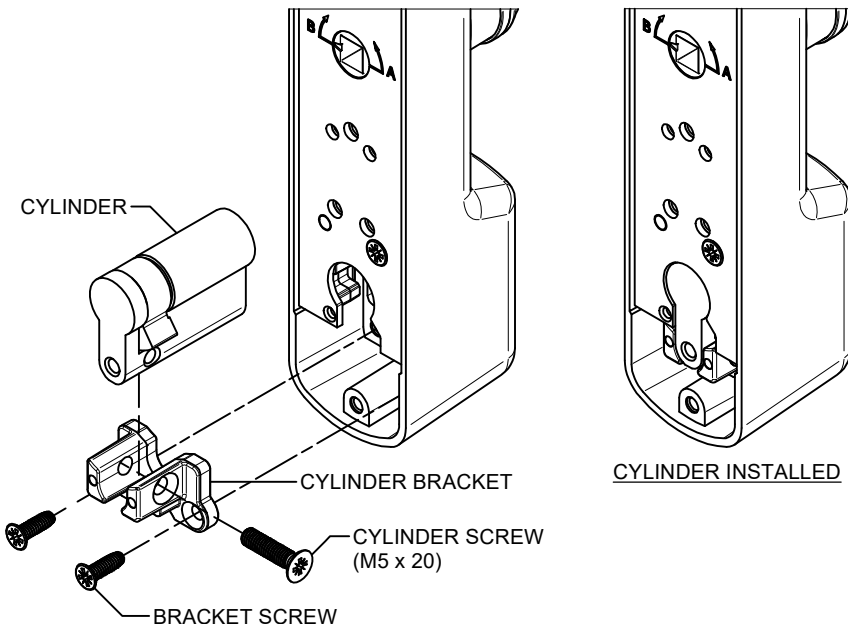

## COMPATIBLE CYLINDER DIMENSIONS

EN 1303 (DIN 18252) EURO PROFILE CYLINDER  
WHEN THE KEY IS REMOVED:  
THE CAM MUST PARK ON THE LEFT HAND SIDE.  
(VIEWED FROM THE FRONT, AS PER DIAGRAM).

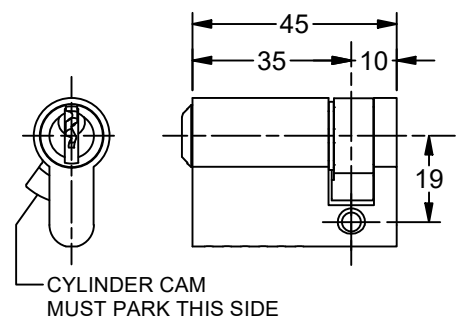

# DEVICE INSTALLATION

## 1 ESTABLISH UNIT POSITION & PREPARE DOOR

WORKING ON THE INSIDE FACE OF THE DOOR.  
 DETERMINE HEIGHT OF THE EXIT DEVICE MAIN UNIT 930mm TO 1130mm FROM FLOOR. SELECT THE CORRECT SIDE OF TEMPLATE (**SL-0083**) TO SUIT THE DOOR HANDING.  
 ALIGN THE TEMPLATE CORRECTLY WITH; THE EDGE OF FRAME (FOR SINGLE DOOR) OR THE EDGE OF 2nd OPENING DOOR (FOR DOUBLE DOORS).  
 MARK THE CENTRES OF ALL SEVEN HOLES (ON THE CORRECT SIDE OF THE TEMPLATE).  
 - PILOT 3 x EXIT DEVICE FIXING HOLES TO SUIT No.8 SCREWS (HOLES L1 / R1).  
 - DRILL 3 x  $\varnothing 5,5\text{mm}$  HOLES FOR OAD FIXINGS THROUGH THE DOOR (HOLES L2 / R2).  
 - DRILL  $\varnothing 22\text{mm}$  SPINDLE HOLE THROUGH THE DOOR (HOLE L3 / R3).  
 FOR EXISTING INSTALLATIONS WHERE AN ACCESS DEVICE IS TO BE RETROFITTED. REMOVE THE EXIT DEVICE & ITS MAIN UNIT MOUNTING PLATE. USE THE TEMPLATE TO IDENTIFY THE CORRECT 3 x OAD FIXING HOLES FROM THE 6 x EXISTING FIXING HOLES. RE-DRILL THESE THROUGH THE DOOR AND OPEN THEM UP TO  $\varnothing 5,5\text{mm}$ .

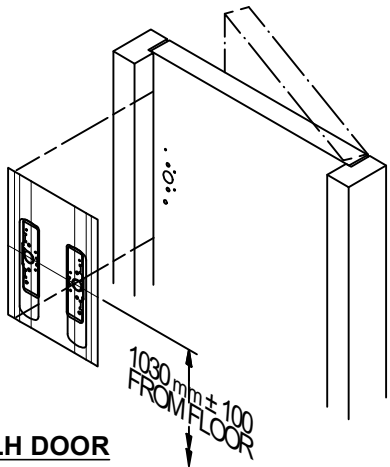

LH DOOR

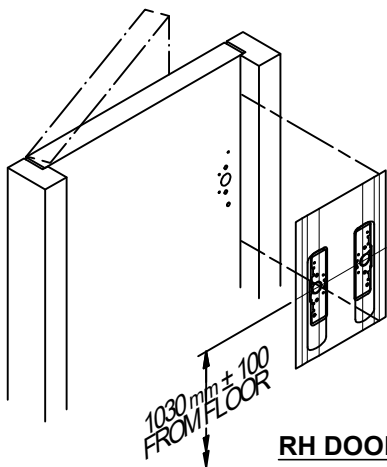

RH DOOR

## 2 PREPARE SPINDLE

MEASURE DOOR THICKNESS ADD 7mm. CUT THE SPINDLE TO THIS LENGTH. DE-BURR THE CUT END.

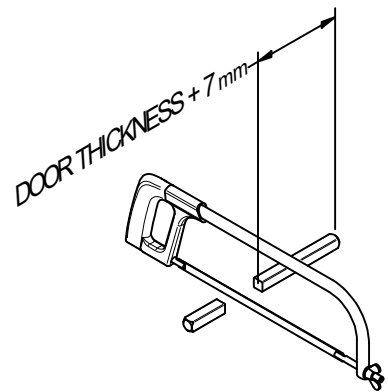

### NOTES ON SPINDLE LENGTH:

THE SUPPLIED SPINDLE IS 103mm LONG.  
 THE SUPPLIED SPINDLE WILL ACCOMMODATE UP TO A THEORETICAL MAXIMUM DOOR THICKNESS OF 96mm.  
 DOORS OVER 65mm THICK HOWEVER REQUIRE LONGER SCREWS (SEE: NOTES, STEP 3)

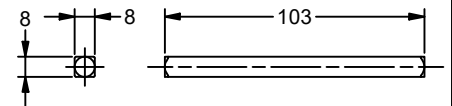

## 3 PREPARE OAD SCREWS

MEASURE DOOR THICKNESS ADD 17mm. CUT 3x **M5 x 82 SCREWS** TO THIS LENGTH.

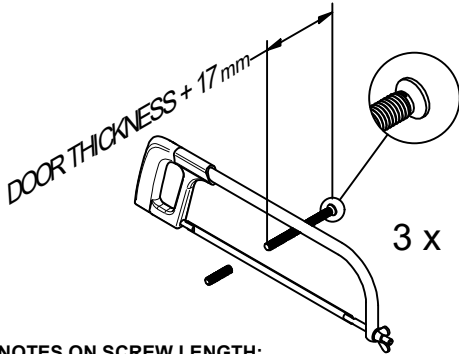

### NOTES ON SCREW LENGTH:

65mm MAX DOOR THICKNESS WITH SUPPLIED 82mm SCREWS.  
 102mm LONG SCREWS ARE AVAILABLE ON REQUEST, TO SUIT DOORS UP TO 85mm THICK

## 5 FIT THE OAD TO THE DOOR

CHECK THE M5 SCREWS (STEP 4) PROJECT 15mm FROM THE OUTSIDE DOOR FACE.  
 LOCATE THE OAD ONTO THE SQUARE SPINDLE. ENSURE THE OAD **DRIVE SPINDLE** MARK IS IN THE CORRECT POSITION TO SUIT THE DOOR HANDING (AS SET IN STEP B).  
 ENSURE THE CAM ON THE MOUNTING PLATE IS IN THE CORRECT ORIENTATION TO SUIT THE DOOR HANDING (SEE DIAGRAMS BELOW).  
 LOCATE THE 3x M5 FIXING SCREWS (PREPARED STEP 3) INTO THE CORRESPONDING HOLES IN THE BACK OF THE OAD AND TIGHTEN TO SECURE THE OAD TO THE DOOR.

LH DOOR

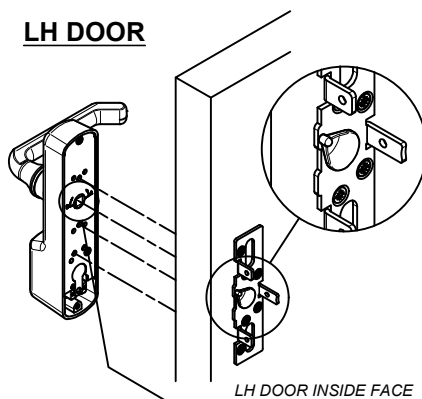

LH DOOR INSIDE FACE

RH DOOR

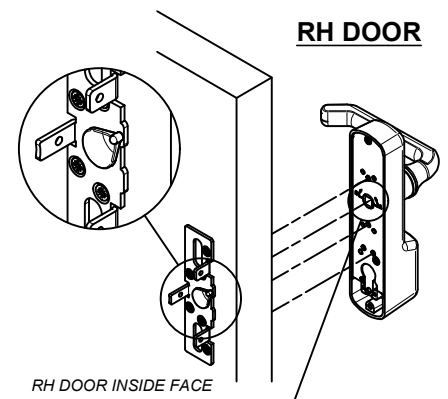

RH DOOR INSIDE FACE

## 4 FIT THE MOUNTING PLATE

LOCATE THE SPINDLE (PREPARED STEP 2) INTO THE SQUARE HOLE IN THE DRIVE CAM ON THE EXIT DEVICE MOUNTING PLATE.  
 FIX THE MOUNTING PLATE ASSY TO DOOR WITH 3x #8 WOOD / SELF TAPPING SCREWS (AS SUPPLIED WITH THE EXIT DEVICE).  
 TRIAL FIT 3 x CUT DOWN **M5 x 82 SCREWS** (PREPARED STEP 3)

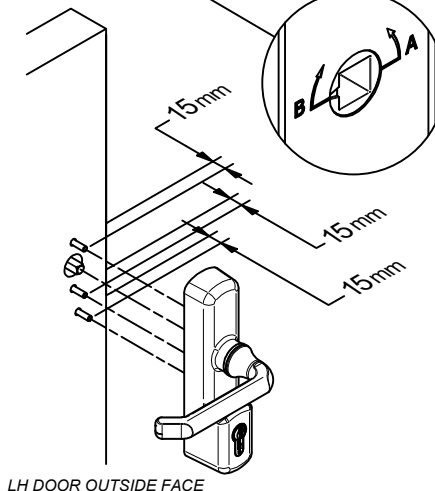
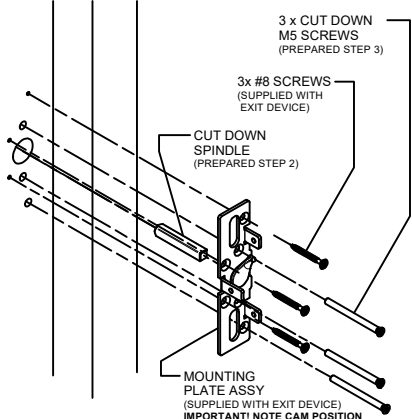

LH DOOR OUTSIDE FACE

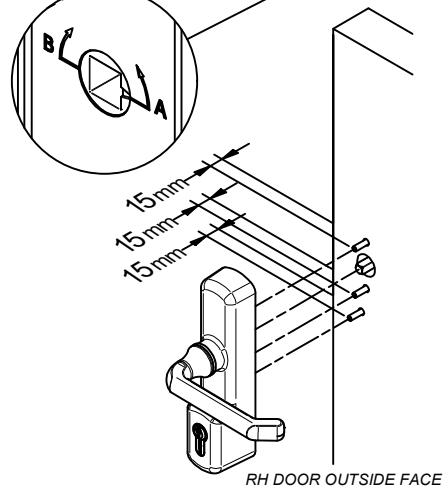

RH DOOR OUTSIDE FACE

# DEVICE INSTALLATION

6

## INSTALL THE EXIT DEVICE

CONTINUE TO INSTALL THE EXIT DEVICE:  
FOLLOWING THE INSTRUCTIONS SUPPLIED WITH THAT DEVICE.

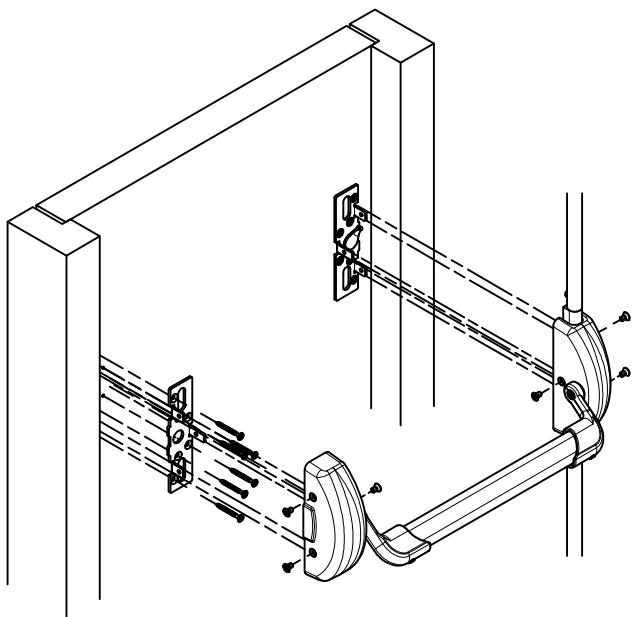

EXAMPLE SHOWN IS A 502A-B UNIT FITTED ON RH DOOR ARRANGEMENT. INFORMATIVE ONLY.

7

## CHECK / TEST INSTALLATION

TEST THE OPERATION OF THE FINISHED INSTALLATION.  
CHECK FOR FREE AND CORRECT OPERATION OF BOTH  
THE OUTSIDE ACCESS DEVICE AND THE PANIC / EMERGENCY  
EXIT HARDWARE.

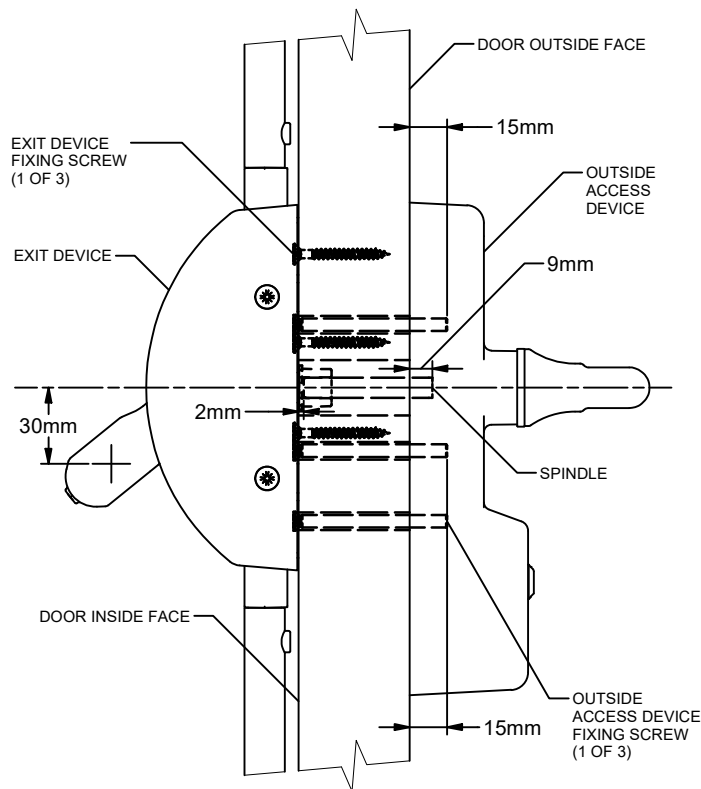

## MAINTENANCE

### WEEKLY:

CHECK THE CORRECT OPERATION OF THE OUTSIDE ACCESS DEVICE  
IN CONJUNCTION WITH THE PANIC / EMERGENCY EXIT DEVICE.

### 3 MONTHLY:

CHECK THAT ALL THE FIXINGS ARE SECURE.

# BOX CONTENTS

BODY ASSY C/W CYLINDER (x1)  
525EC / 526EC ONLY  
(P3881)

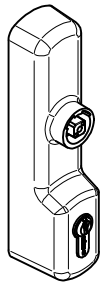

BODY ASSY W/O CYLINDER (x1)  
525EA / 526EA ONLY  
(P3880)

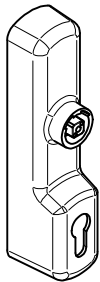

SPINDLE (x1)  
(CONNECTS OAD TO EXIT DEVICE)  
(SCR623455 - PACK)

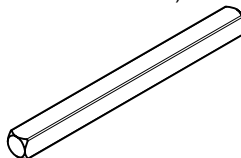

3mm A/F HEX KEY (x1)  
(SCR623455 - PACK)



LEVER HANDLE (x1)  
525 OAD ONLY  
(P3804)



KNOB (x1)  
526 OAD ONLY  
(P3805)



M5 x 82 SMALL CSK HEAD SCREW (x3)  
(FOR FIXING OAD TO DOOR,  
SCREWS THROUGH MOUNTING PLATE)  
(SCR623455 - PACK)

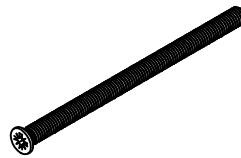

TEMPLATE (x1)  
(SL-0083)

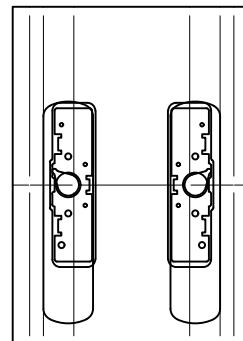

WASHER (x1)  
SUPPLIED IN SCREW PACK  
(P3816)



M5 x 20 CSK HEAD SCREW (x1)  
FOR CYLINDER FIXING  
(SCR623455 - PACK)



STOP PIECE (x1)  
525 OAD ONLY, SUPPLIED IN SCREW PACK  
(P3820)



M4 x 35 CAP HEAD SCREW (x1)  
FOR FIXING LEVER / KNOB  
(SCR623455 - PACK)

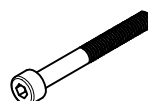

EXIDOR LTD.

PROGRESS DRIVE, CANNOCK, STAFFORSHIRE, WS11 0JE  
Tel. +44 (0) 1543 578661 Fax. +44 (0) 1543 570050

web. [www.exidor.co.uk](http://www.exidor.co.uk)